

DOUBLE U SHEAR MOUNT

Double U Shear Mounting are manufactured in four different sizes such as GR-211, GR-212, GR-213, GR-214.

Double U Shear mounts are soft in nature & it has a spring action. Double U Shear mounts are capable of absorbing shocks & vibrations in vertical & as well as lateral directions. The designs incorporates built in protection against metal to metals bonding. A wider base provide stability in the installed equipment. Double U Shear Mountings can be prepared as pre compressed. Double U Shear mountings are used for instruments, electronics apparatus protecting to equipment in packing cases, suspending light components, recorders in a vibrating equipment, electrically controlled panels, suspending ducts pipe lines & high speed motors for hydraulic power packs, buffers etc.

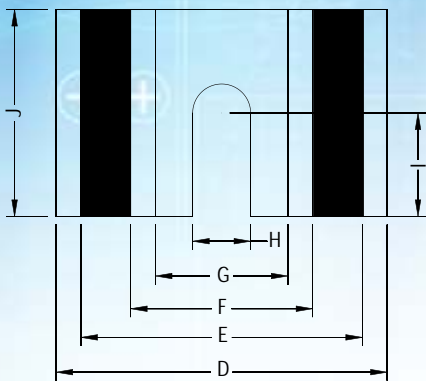
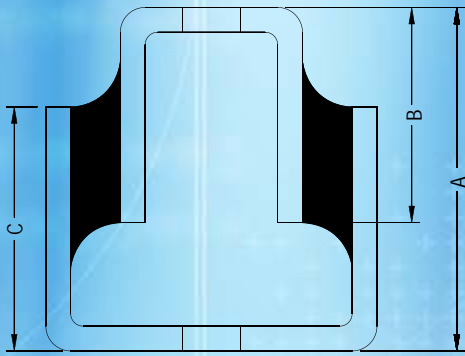

PART NO.	MAX. LOAD CAPACITY (kg)	DEFLECTION (mm)
GR-211	31.5	5.7
GR-212	57.5	5.7
GR-213	100	5.7
GR-214	210	5.7

PARTS NAME	GR-211	GR-212	GR-213	GR-214
A	44	64	83	112
B	24	38	52	77
C	33	44	59	86
D	61	71	80	90
E	64	61	68	76
F	24	30	44	51
G	17	25	32	39
H	11	10	14	15
I	25	12	25	32
J	51	25	50	63