

## CUSHYFOOT MOUNTING GR-131

Cushyfoot Mounting are manufactured in three standard sizes known as GR-131, GR-132, GR-133 "S" . GR BOND Cushyfoot Mounting consists of two sandwich pieces. These two pieces are housed in specially designed robust iron casting. The mountings are protected against oil, physical & mechanical damages. Cushyfoot mountings give insulation against transverse, vertical and longitudinal stiffness, vibration & reduces transmission of vibrations, structure borne noise & shock from a wide range of rotating and reciprocating machineries. Also protecting sensitive apparatus for external disturbances . It gives insulation against out of balance forces. These mounting has very low natural frequencies up to 5.5Hz & has very good lateral stability. For low disturbing frequencies, high deflection can be achieved by screwing two cusyfoot mounting together.

### APPLICATION

No. need to bolt the machine. No need of grouting in rag bolt. The cushyfoot mounting can be supplied with bottom friction Pads to avoid costly groutings/Anchoring to floor the equipment. Additionally, shifting of the location of the instrumentation with very less effects.

### DESIGN FEATURES

- Inclined rubber sandwich are first grade natural rubber to metal bonded elements
- Rubber sandwich elements are effectively protected by the top casting and its extended skirt
- Standard C.I.Castings
- Two different horizontal stiffness axis enable optimum system characteristics & vibration isolation to be achieved using careful orientation of the mounting
- Static deflection upto 5.2mm with loads from 80 to 320 kg per mountings

### TYPICAL APPLICATION

- Diesel Generator sets including mobile sets
- Axial & Centrifugal Pump Sets
- Air Handling units
- Refrigeration Plant
- Pumps & Compressor
- Lift Motor Gear
- Blowers
- Food Process Machineries Engine Mountings
- Printing Machineries
- Precision Grinders
- Polishers
- Electric Engines
- Chiller & Cooling Towers
- Vibrating Screen & Hoppers

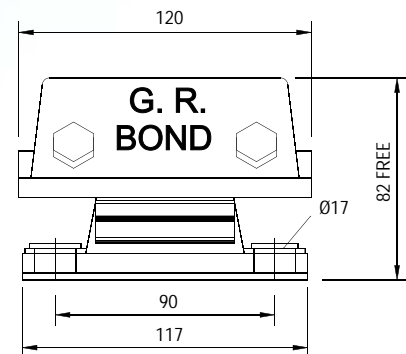
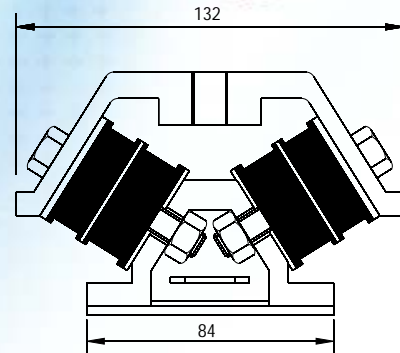

PART NO.	COLOUR CODE	HARDNESS SHORE	DEFLECTION (mm)	MAX. LOAD CAPACITY	TOP FIXING HOLE	
					PLAIN	TAPPED
GR-131-1	BLUE	45	5.5	77	10	M16 & M12
GR-131-2	WHITE	55	5.7	118		
GR-131-3	GREEN	65	6.0	150		
GR-131-4	BROWN	70	5.7	230		
GR-131-5	RED	80	5.2	315		

### PARTH INDUSTRIES

SHEAD NO. C1/B6, PLOT NO. 65/6, OPP BANK OF BARODA,  
 F ROAD, PHASE-1, GIDC VATVA, AHMEDABAD-382445  
 PH: +91-79-25831548, 32203031, MO:- 91-9327013167-9374025121  
 Web:- www.parthind.com, E-mail:- hasmukh@parthind.com

## CUSHYFOOT MOUNTING GR-132



ANTI VIBRATION MOUNTING PAD

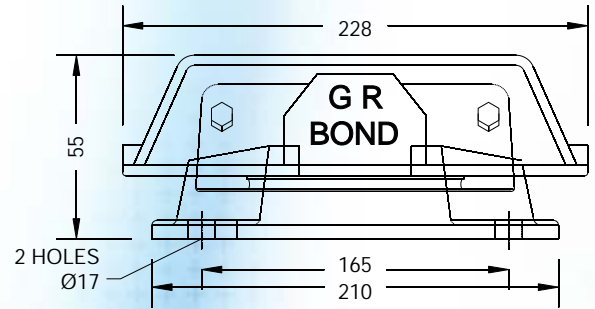
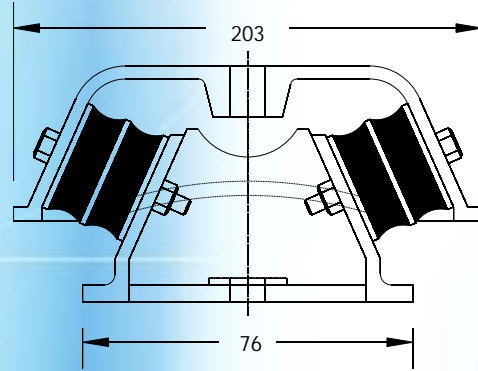

PART NO.	COLOUR CODE	HARDNESS SHORE	DEFLECTION (mm)	MAX. LOAD CAPACITY	TOP FIXING HOLE	
					PLAIN	TAPPED
GR-132-1	BLUE	45	5.7	270	10	M16
GR-132-2	WHITE	55	5.7	540		
GR-132-3	GREEN	65	5.7	850		
GR-132-4	YELLOW	70	5.7	1040		
GR-132-5	RED	80	5.7	1580		

## CUSHYFOOT MOUNTING GR-133 "S" TYPE

The GR BOND "S" type cushyfoot mountings are designed for the light weight four cycle and high speed multi cylinder engine.

GR BOND Cushyfoot Mounting consists of two sandwich pieces. These two pieces are housed in specially designed robust iron casting. The mountings are protected against oil, physical & mechanical damages. Cushyfoot mountings gives insulation against transverse, vertical and longitudinal stiffness, vibration & reduces transmission of vibration structure borne noise & shock from a wide range of rotating and reciprocating machineries. Also protecting sensitive apparatus external disturbances. It gives insulation against out of balance forces. These mounting has very low natural frequencies up to 5.5Hz & has very good lateral stability.

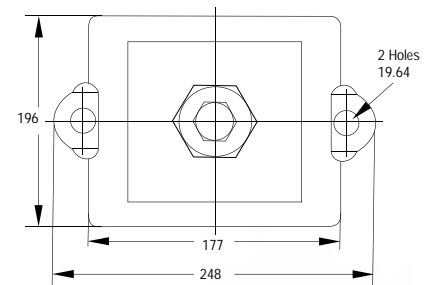
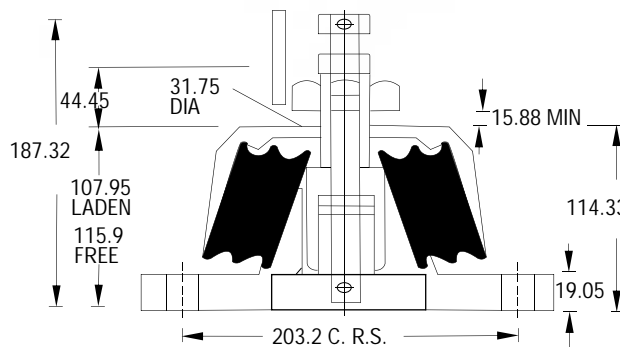

SECTION VIEW

### PARTH INDUSTRIES

SHEAD NO. C1/B6, PLOT NO. 65/6, OPP BANK OF BARODA,  
F ROAD, PHASE-1, GIDC VATVA, AHMEDABAD-382445  
PH: +91-79-25831548, 32203031, MO:- 91-9327013167-9374025121  
Web:- www.parthind.com, E-mail:- hasmukh@parthind.com

